



Boise Cascade
Engineered Wood Products

EASTERN ENGINEERED WOOD PRODUCTS

BCI[®] 90e PRODUCT GUIDE



Introducing a new
LVL flange series -
the **BCI[®] 90e**

BCI[®] 90e 2.0

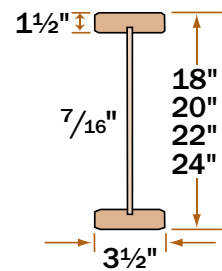

2x4 flange

Available in depths 18" to 24"

Exceeds the properties and spans of the PRI-90



US Version

Special Order

08/24/09

BCI® Joist Series	Depth [inches]	Weight [plf]	Moment [ft-lbs]	EI x 10 ⁶ [lb-in ²]	K x 10 ⁶ [lbs]	Shear [lbs]	End Reaction [lbs]				Intermediate Reaction [lbs]			
							1¼" Bearing		3½" Bearing		3½" Bearing		5¼" Bearing	
							No WS ⁽¹⁾	WS ⁽²⁾	No WS ⁽¹⁾	WS ⁽²⁾	No WS ⁽¹⁾	WS ⁽²⁾	No WS ⁽¹⁾	WS ⁽²⁾
BCI® 90e 2.0	18	5.1	14985	1620	12.0	2750	N/A ⁽³⁾	2240	N/A ⁽³⁾	2550	N/A ⁽³⁾	4150	N/A ⁽³⁾	4720
	20	5.4	16795	2056	13.3	2850	N/A ⁽³⁾	2500	N/A ⁽³⁾	2650	N/A ⁽³⁾	4300	N/A ⁽³⁾	4850
	22	5.6	18610	2548	14.6	3235	N/A ⁽³⁾	2638	N/A ⁽³⁾	3150	N/A ⁽³⁾	5230	N/A ⁽³⁾	5505
	24	5.9	20420	3099	15.9	3440	N/A ⁽³⁾	2638	N/A ⁽³⁾	3320	N/A ⁽³⁾	5345	N/A ⁽³⁾	5900

NOTES:

- (1) No web stiffeners required.
- (2) Web stiffeners required.
- (3) Not applicable, web stiffeners required.
 - Moment, shear and reactions values based upon a load duration of 100% and may be adjusted for other load durations.
 - Design values listed are applicable for Allowable Stress Design (ASD).
 - No additional repetitive member increased allowed.

$$\Delta = \frac{5wl^4}{384EI} + \frac{wl^2}{K}$$

Δ = deflection [in]
 w = uniform load [lb/in]
 l = clear span [in]
 EI = bending stiffness [lb-in²]
 K = shear deformation coefficient [lb]

BUILDING CODE EVALUATION REPORTS

- ICC ESR 1336 (IBC, IRC)

Web Stiffener Requirements

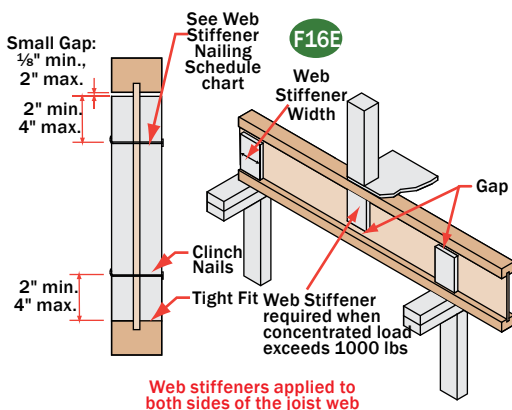

Web stiffeners applied to both sides of the joist web

Web Stiffener Size			
Series	Minimum Thickness		Minimum Width
	In Hanger	No Hanger	
BCI® 90e 2.0	2x4 lumber (vertical)		

Web Stiffener Nailing Schedule			
BCI® Joist Series	Joist Depth	Bearing Location	
		End	Intermediate
BCI® 90e 2.0	18"	7-16d	7-16d
	20"-24"	8-16d	8-16d

NOTES

- Web stiffeners are always required for all 18" and deeper BCI® Joists at all bearing locations.
- Web stiffeners are always required in hangers that do not extend up to support the top flange of the BCI® Joist. Web stiffeners may be required with certain sloped or skewed hangers or to achieve uplift values. Refer to the hanger manufacturer's installation requirements.
- Web stiffeners are always required in certain roof applications, see BCI® Installation Guide for further details.
- Web stiffeners are always required under concentrated loads that exceed 1000 pounds. Install the web stiffeners snug to the top flange in this situation. Follow the nailing schedule for intermediate bearings.

Allowable Uniform Floor Load (in pounds per linear foot [PLF])

100% Load Duration								
	18" BCI® 90e 2.0		20" BCI® 90e 2.0		22" BCI® 90e 2.0		24" BCI® 90e 2.0	
	Live Load	Total Load	Live Load	Total Load	Live Load	Total Load	Live Load	Total Load
10	-	332	-	344	-	418	-	427
11	-	301	-	312	-	380	-	388
12	-	276	-	286	-	348	-	356
13	-	255	-	264	-	321	-	328
14	-	237	-	245	-	298	-	305
15	-	221	-	229	-	278	-	285
16	-	207	-	215	-	261	-	267
17	-	195	-	202	-	246	-	251
18	-	184	-	191	-	232	-	237
19	-	174	-	181	-	220	-	225
20	-	166	-	172	-	209	-	213
21	-	158	-	163	-	199	-	203
22	147	150	-	156	-	190	-	194
23	130	144	-	149	-	181	-	185
24	115	138	-	143	-	174	-	178
25	103	132	129	137	157	167	-	171
26	92	127	115	132	141	160	-	164
27	83	122	104	127	127	154	153	158
28	75	118	94	122	115	149	138	152
29	67	114	85	118	104	144	125	147
30	61	110	77	114	95	139	114	142
32	51	102	64	107	79	130	95	133
34	43	86	54	101	66	123	80	125
36			46	92	56	113	68	118
38					48	96	58	112
40					41	83	50	101

- Total Load values are limited by shear, moment, or deflection equal to L/240.
- Live Load values are limited by deflection equal to L/480. For deflection limits of L/360 and L/960, multiply the Live Load values by 1.33 and 0.50 respectively.
- Both the Total Load and Live Load columns must be checked. Where a Live Load value is not shown, the Total Load value will control.
- Table values apply to either simple or multiple span joists. Span is measured center to center of the minimum required bearing length. Analyze multiple span joists with the BC CALC® software if the length of any span is less than half the length of an adjacent span.
- Table values do not consider composite action from gluing and nailing floor sheathing.
- Total load values assume minimum bearing lengths with web stiffeners.
- This table was designed to apply to a broad range of applications. It may be possible to exceed the limitations of this table by analyzing a specific application with the BC CALC® software.

Joist Series	Joist Depth	Residential Floor Multi-Family Dwellings Hotels - Private Rooms				Office Buildings – Office Area			
		40 psf Live Load / 25 psf Dead Load				50 psf Live Load + 15 psf Partition Load / 25 psf Dead Load & 2000 lb Concentrated Load			
		L/480 Live Load Deflection Limit				L/600 Live Load Deflection Limit at 50 psf Live Load L/360 Live Load Deflection Limit at 65 psf Live Load			
		12" o.c.	16" o.c.	19.2" o.c.	24" o.c.	12" o.c.	16" o.c.	19.2" o.c.	24" o.c.
BCI® 90e	18"	35'-10"	32'-7"	30'-9"	25'-5"	30'-7"	27'-6"	22'-11"	18'-4"
	20"	38'-9"	35'-4"	32'-11"	26'-4"	33'-2"	28'-6"	23'-9"	19'-0"
	22"	41'-7"	37'-11"	35'-9"	32'-0"	35'-7"	32'-5"	28'-11"	23'-1"
	24"	44'-5"	40'-6"	38'-2"	32'-9"	38'-0"	34'-7"	29'-7"	23'-7"

Joist Series	Joist Depth	Office Buildings - Lobbies & Corridors Hotels - Public Rooms & Corridors				Warehouse - Light Storage			
		100 psf Live Load / 25 psf Dead Load & 2000 lb Concentrated Load				125 psf Live Load / 25 psf Dead Load			
		L/600 Live Load Deflection Limit at 50 psf Live Load L/360 Live Load Deflection Limit at 100 psf Live Load				L/600 Live Load Deflection Limit at 50 psf Live Load L/360 Live Load Deflection Limit at 125 psf Live Load			
		12" o.c.	16" o.c.	19.2" o.c.	24" o.c.	12" o.c.	16" o.c.	19.2" o.c.	24" o.c.
BCI® 90e	18"	26'-5"	19'-9"	16'-5"	13'-2"	22'-0"	16'-5"	13'-8"	10'-11"
	20"	27'-4"	20'-6"	17'-1"	13'-7"	22'-9"	17'-1"	14'-2"	11'-4"
	22"	33'-4"	24'-11"	20'-9"	16'-7"	27'-9"	20'-9"	17'-3"	13'-10"
	24"	34'-1"	25'-6"	21'-3"	16'-11"	28'-4"	21'-3"	17'-8"	14'-1"

NOTES

- Spans limited by allowable moment and reaction values, total load deflection of L/240 and live load deflections noted. No other floor performance limits have been imposed. Floor performance should be considered in the design, contact Boise EWP Engineering for further information.
- Table values assume that $2\frac{3}{32}$ " min. plywood/OSB rated sheathing is glued and nailed to joists.
- Table values represent the most restrictive of simple or multiple span applications.
- Table values are the maximum allowable clear distance between supports.
- Live loads based upon Table 1607.1 of 2006 International Building Code.
- Floor covering such as tile may require more restrictive deflection limits, contact Boise EWP Engineering for further information.
- Table values assume minimum bearing lengths with web stiffeners at each bearing.
- This table was designed to apply to a broad range of applications. It may be possible to exceed the limitations of this table by analyzing a specific application with the BC CALC® sizing software.

Deflection Criteria for Commercial Floors

The minimum deflection criterion for commercial floors is the same as for residential floors, L/360 for live load deflection and L/240 for total load deflection. Since deflection controls a significant amount of I-joist designs, an additional deflection limit has been considered in the development of the BCI® joist span tables shown in this guide. In addition to the minimum limits at full uniform and concentrated ("safe") live loads, deflection is limited to L/600 with a uniform live load of 50 psf in those tables where the code specified uniform live load is 50 psf or greater. As is the case with all joist designs, floor performance should always be considered by the design professional of record in each specific condition.

Additional floor framing details available with BC FRAMER® software

END BEARING DETAILS

F07

Nail Boise Rimboard to BCI® Joists with 8d nail into each flange. Dimension lumber is not suitable for use as rim board with BCI® Joists.

F07A

Dimension lumber is not suitable for use as rim board with BCI® Joists.

F02

BCI® rim joist.
Minimum 2x6 wall for proper bearing support.

F01

BCI® Joist blocking.

F27A

Top Flange or Face Mount Joist Hanger
VERSA-LAM®

F52

One 8d nail each side at bearing
1 3/4" minimum bearing length
To limit splitting flange, start nails at least 1 1/2" from end. Nails may need to be driven at an angle to limit splitting of bearing plate.

F08

Solid block all posts from above to bearing below.

F03

BCI® rim joist.
Minimum 2x6 wall for proper bearing support.
Note: BCI® floor joist must be designed to carry wall above when not stacked over wall below.

INTERMEDIATE BEARING DETAILS

F06

For load bearing wall above (stacked over wall below).

BCI® Joist blocking.

F09

Blocking may be required, consult design professional of record and/or local building official.

1/16" gap
2x block
Load bearing wall above (stacked over wall below)

Double Squash Block Vertical Load [lb/ft]

Size	Joist Spacing [in]			
	12	16	19.2	24
2x4	4463	3347	2789	2231
2x6	7013	5259	4383	3506

- Squash blocks are to be in full contact with upper floor and lower wall plate.
- Capacities shown are for a double squash blocks at each joist, SPF or better.

F15D Connection on Steel Beam

Sill plate to be properly anchored to steel beam
Steel beam

F10

Backer block (minimum 12" wide). Nail with 10-10d nails.
Joist Hanger
Filler block. Nail with 10-10d nails
Backer block required where top flange joist hanger load exceeds 250 lbs. Install tight to top flange.

F58

Double BCI® Joist Connection

Filler Block (see chart below)
Web-Filler Nailing 12" on-center
Connection valid for all applications. Contact Boise EWP Engineering for specific conditions.

F05

Sheathing or rimboard closure
BCI® Joist blocking required for cantilever.

F15E Connection with Hanger on Steel Beam

Sill plate to be properly anchored to steel beam
Steel beam
Backer block optional

BACKER AND FILLER BLOCK DIMENSIONS

Series	Backer Block Thickness	Filler Block Thickness
BCI® 90 2.0	2x_ lumber	Double 2x_ lumber

- Cut backer and filler blocks to a maximum depth equal to the web depth minus 1/4" to avoid a forced fit.
- For deeper BCI® 90e Joists, stack 2x lumber or use multiple pieces of 3/4" wood panels.

BCI® RIM JOISTS AND BCI® BLOCKING

Depth [in]	Series	Vertical Load Capacity	
		No W.S.(1)	W.S.(2)
18"-24"	BCI® 90e 2.0	N/A	2700

- (1) No web stiffeners required
- (2) Web stiffeners required at each end of blocking, values not applicable for rim joists

N/A: Not applicable

WEB STIFFENER REQUIREMENTS

- See *Web Stiffener Requirements* on page 2.

PROTECT BCI® JOISTS FROM THE WEATHER

- BCI® Joists are intended only for applications that provide permanent protection from the weather. Bundles of BCI® Joists should be covered and stored off of the ground on stickers.

BCI® Joist Hole Location & Sizing

BCI® Joists are manufactured with 1½" round perforated knockouts in the web at approximately 12" on center

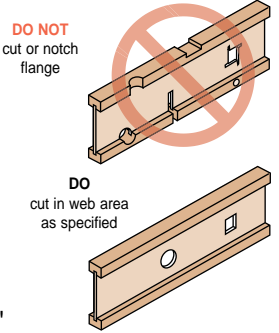
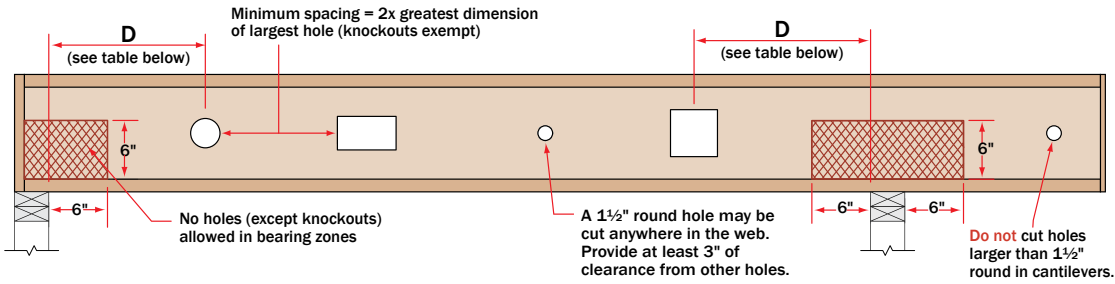

Minimum distance from support, listed in table below, is required for all holes greater than 1½"

MINIMUM DISTANCE (D) FROM ANY SUPPORT TO THE CENTERLINE OF THE HOLE																
Round Hole Diameter [in]	2	3	4	5	6	6½	7	8	8¾	9	10	11	12	13		
Rectangular Hole Side [in]	-	-	-	-	-	-	-	2	3	3	5	6	7	9		
18" BCI® 90e	Span [ft]	8	1'-0"	1'-1"	1'-2"	1'-2"	1'-3"	1'-4"	1'-6"	1'-11"	2'-3"	2'-3"	2'-8"	3'-0"	3'-5"	3'-9"
		12	1'-0"	1'-1"	1'-2"	1'-2"	1'-9"	2'-0"	2'-4"	2'-10"	3'-4"	3'-5"	4'-0"	4'-6"	5'-1"	5'-8"
		16	1'-0"	1'-1"	1'-2"	1'-7"	2'-4"	2'-9"	3'-1"	3'-10"	4'-6"	4'-7"	5'-4"	6'-1"	6'-10"	7'-7"
		20	1'-0"	1'-1"	1'-2"	2'-0"	2'-11"	3'-5"	3'-11"	4'-10"	5'-7"	5'-9"	6'-8"	7'-7"	8'-6"	9'-5"
		24	1'-0"	1'-1"	1'-4"	2'-5"	3'-7"	4'-1"	4'-8"	5'-9"	6'-9"	6'-11"	8'-0"	9'-1"	10'-3"	11'-4"
		28	1'-0"	1'-1"	1'-7"	2'-10"	4'-2"	4'-10"	5'-5"	6'-9"	7'-11"	8'-1"	9'-4"	10'-8"	11'-11"	13'-3"
Round Hole Diameter [in]	2	3	4	5	6	6½	7	8	8¾	9	10	11	12	13		
Rectangular Hole Side [in]	-	-	-	-	-	-	-	-	2	2	3	5	6	7		
20" BCI® 90e	Span [ft]	8	1'-0"	1'-1"	1'-2"	1'-2"	1'-3"	1'-3"	1'-7"	1'-10"	1'-10"	2'-2"	2'-6"	2'-10"	3'-2"	
		12	1'-0"	1'-1"	1'-2"	1'-2"	1'-4"	1'-7"	1'-10"	2'-4"	2'-9"	2'-10"	3'-4"	3'-10"	4'-4"	4'-10"
		16	1'-0"	1'-1"	1'-2"	1'-2"	1'-10"	2'-2"	2'-6"	3'-2"	3'-9"	3'-9"	4'-5"	5'-1"	5'-9"	6'-5"
		20	1'-0"	1'-1"	1'-2"	1'-6"	2'-4"	2'-8"	3'-1"	3'-11"	4'-8"	4'-9"	5'-7"	6'-5"	7'-2"	8'-0"
		24	1'-0"	1'-1"	1'-2"	1'-9"	2'-9"	3'-3"	3'-9"	4'-9"	5'-7"	5'-8"	6'-8"	7'-8"	8'-8"	9'-8"
		28	1'-0"	1'-1"	1'-2"	2'-1"	3'-3"	3'-10"	4'-4"	5'-6"	6'-6"	6'-8"	7'-10"	8'-11"	10'-1"	11'-3"
Round Hole Diameter [in]	2	3	4	5	6	6½	7	8	8¾	9	10	11	12	13		
Rectangular Hole Side [in]	-	-	-	-	-	-	-	-	-	-	2	3	5	6		
22" BCI® 90e	Span [ft]	10	1'-0"	1'-1"	1'-2"	1'-2"	1'-3"	1'-5"	1'-7"	1'-11"	2'-2"	2'-3"	2'-7"	2'-11"	3'-3"	3'-7"
		14	1'-0"	1'-1"	1'-2"	1'-3"	1'-9"	2'-0"	2'-2"	2'-8"	3'-1"	3'-2"	3'-8"	4'-1"	4'-7"	5'-1"
		18	1'-0"	1'-1"	1'-2"	1'-7"	2'-3"	2'-7"	2'-10"	3'-6"	4'-0"	4'-1"	4'-8"	5'-4"	5'-11"	6'-7"
		22	1'-0"	1'-1"	1'-3"	2'-0"	2'-9"	3'-1"	3'-6"	4'-3"	4'-11"	5'-0"	5'-9"	6'-6"	7'-3"	8'-0"
		26	1'-0"	1'-1"	1'-6"	2'-4"	3'-3"	3'-8"	4'-2"	5'-0"	5'-10"	5'-11"	6'-10"	7'-8"	8'-7"	9'-6"
		30	1'-0"	1'-1"	1'-8"	2'-9"	3'-9"	4'-3"	4'-9"	5'-10"	6'-8"	6'-10"	7'-10"	8'-11"	9'-11"	10'-11"
Round Hole Diameter [in]	2	3	4	5	6	6½	7	8	8¾	9	10	11	12	13		
Rectangular Hole Side [in]	-	-	-	-	-	-	-	-	-	-	-	2	3	4		
24" BCI® 90e	Span [ft]	10	1'-0"	1'-1"	1'-2"	1'-2"	1'-3"	1'-3"	1'-6"	1'-9"	1'-9"	2'-1"	2'-5"	2'-9"	3'-1"	
		14	1'-0"	1'-1"	1'-2"	1'-2"	1'-3"	1'-5"	1'-7"	2'-1"	2'-5"	2'-6"	3'-0"	3'-5"	3'-10"	4'-4"
		18	1'-0"	1'-1"	1'-2"	1'-2"	1'-6"	1'-10"	2'-1"	2'-8"	3'-2"	3'-3"	3'-10"	4'-5"	5'-0"	5'-7"
		22	1'-0"	1'-1"	1'-2"	1'-2"	1'-10"	2'-2"	2'-7"	3'-3"	3'-11"	4'-0"	4'-8"	5'-5"	6'-1"	6'-10"
		26	1'-0"	1'-1"	1'-2"	1'-4"	2'-2"	2'-7"	3'-0"	3'-10"	4'-7"	4'-8"	5'-6"	6'-5"	7'-3"	8'-1"
		30	1'-0"	1'-1"	1'-2"	1'-7"	2'-6"	3'-0"	3'-6"	4'-6"	5'-4"	5'-5"	6'-5"	7'-4"	8'-4"	9'-4"

- Select a table row based on joist depth and the actual joist span rounded up to the nearest table span. Scan across the row to the column headed by the appropriate round hole diameter or rectangular hole side. Use the longest side of a rectangular hole. The table value is the closest that the centerline of the hole may be to the centerline of the nearest support.
- The entire web may be cut out. **DO NOT** cut the flanges. Holes apply to either single or multiple joists in repetitive member conditions.
- For multiple holes, the amount of uncut web between holes must equal at least twice the diameter (or longest side) of the largest hole.
- 1½" round knockouts in the web may be removed by using a short piece of metal pipe and hammer.
- Holes may be positioned vertically anywhere in the web. The joist may be set with the 1½" knockout holes turned either up or down.
- This table was designed to apply to the design conditions covered by tables elsewhere in this publication. Use the BC CALC® software to check other hole sizes or holes under other design conditions. It may be possible to exceed the limitations of this table by analyzing a specific application with the BC CALC® software.

One-Hour Floor/Ceiling Assembly

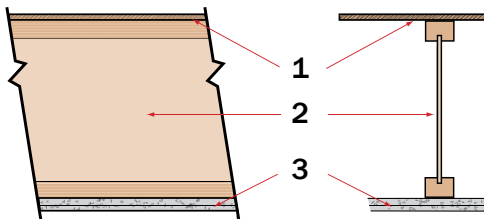

FIRE ASSEMBLY COMPONENTS

1. Min. ¾" tongue-and-groove plywood or 23/32" APA Rated Sheathing (Exposure 1 or exterior glue)
2. BCI® Joists at 24" o.c. or less.
3. Two layers ½" Type C or two layers 5/8" Type X gypsum board
4. When constructed with resilient channels, STC = 50.

ICC Evaluation Report ESR 1336

Contact your local Boise EWP representative for specific assembly information and other fire-resistive options.

Allowable Uniform Roof Load (in pounds per linear foot [PLF])

115% and 125% Load Duration

Use of these tables should be limited to roof slopes of 3½" per foot or less.
For steeper slopes, use BC CALC® software.

Span Length	BCI® 90e 2.0 Series 3½" Flange Width											
	18" BCI® 90s 2.0			20" BCI® 90s 2.0			22" BCI® 90s 2.0			24" BCI® 90s 2.0		
	Total Load		Deflect.	Total Load		Deflect.	Total Load		Deflect.	Total Load		Deflect.
	Snow (115%)	Non-Snow (125%)	L/240	Snow (115%)	Non-Snow (125%)	L/240	Snow (115%)	Non-Snow (125%)	L/240	Snow (115%)	Non-Snow (125%)	L/240
6	623	677	-	646	702	-	785	854	-	803	873	-
7	534	581	-	553	602	-	673	732	-	688	748	-
8	467	508	-	484	526	-	589	640	-	602	654	-
9	415	451	-	430	468	-	523	569	-	535	582	-
10	374	406	-	387	421	-	471	512	-	481	523	-
11	340	369	-	352	383	-	428	465	-	438	476	-
12	311	338	-	323	351	-	392	427	-	401	436	-
13	287	312	-	298	324	-	362	394	-	370	402	-
14	267	290	-	276	301	-	336	366	-	344	374	-
15	249	271	-	258	280	-	314	341	-	321	349	-
16	233	254	-	242	263	-	294	320	-	301	327	-
17	220	239	-	228	247	-	277	301	-	283	308	-
18	207	225	-	215	234	-	261	284	-	267	291	-
19	196	214	-	204	221	-	248	269	-	253	275	-
20	187	203	-	193	210	-	235	256	-	240	261	-
21	178	193	-	184	200	-	224	244	-	229	249	-
22	170	184	-	176	191	-	214	232	-	219	238	-
23	162	176	-	168	183	-	205	222	-	209	227	-
24	155	169	-	161	175	-	196	213	-	200	218	-
25	149	162	-	155	168	-	188	205	-	192	209	-
26	143	156	-	149	162	-	181	197	-	185	201	-
27	138	150	-	143	156	-	174	189	-	178	194	-
28	133	145	-	138	150	-	168	183	-	172	187	-
29	129	140	126	133	145	-	162	176	-	166	180	-
30	124	135	114	129	140	-	157	170	-	160	174	-
31	120	131	104	125	135	-	152	165	-	155	168	-
32	116	124	95	121	131	119	147	160	146	150	163	-
33	113	113	87	117	127	109	142	155	134	146	158	-
34	104	104	79	114	123	100	138	150	123	141	154	-
35	95	95	73	110	120	92	134	146	113	137	149	-
36	88	88	67	107	111	85	129	137	104	133	145	126
37	81	81	62	102	102	78	122	126	96	130	141	117
38	75	75	57	95	95	72	116	117	89	126	137	108
39	70	70	53	88	88	67	108	108	83	121	131	100
40	65	65	49	82	82	62	101	101	77	115	122	93

- Total Load values are limited by shear, moment, or deflection equal to L/180.
- Deflection values (Deflect.) are limited by live load deflection equal to L/240. Check the local building code for other deflection limits that may apply.
- Both the Total Load and Deflection columns must be checked. Where a Deflection value is not shown, the Total Load value will control.

- Table values apply to either simple or multiple span joists. Span is measured center to center of the minimum required bearing length. Analyze multiple span joists with the BC CALC® software if the length of any span is less than half the length of an adjacent span.
- Slope roof joists at least ¼ inch over 12 inches to minimize ponding.
- Table values assume minimum bearing lengths with web stiffeners.

- This table was designed to apply to a broad range of applications. It may be possible to exceed the limitations of this table by analyzing a specific application with the BC CALC® software.
- Allowable spans and loads shall be adjusted and checked for wind load as required by local building code.



Boise Cascade has a proven track record of providing quality wood products and a nationwide building materials distribution network for our customers, helping them to enhance their own businesses.

Boise Engineered Wood Products build better homes with stronger, stiffer floors using only wood purchased in compliance with Sustainable Forestry Initiative (SFI) programs. Take a moment to view our green brochure at http://www.bc.com/wood/ewp/Boise_EWP_Green.html.

Boise Cascade buys wood fiber in compliance with SFI®, the Sustainable Forestry Initiative®, and is an SFI chain-of-custody certified national supplier. Chain-of-custody tracks and records possession and transfer of wood fiber from forest of origin through all stages of distribution and production to the homebuilder. Chain-of-custody assures that Boise Cascade products are made using fiber from responsibly-managed forests and not from areas that are illegally harvested, major tropical wilderness areas or biodiversity hotspots. Boise Cascade's computerized chain-of-custody system documents sourcing of all wood fiber purchased, ensuring that none gets into Boise Cascade inventory unless it comes from acceptable sources.



Lifetime Guaranteed Quality and Performance

Boise Cascade warrants its BCI® Joist, VERSA-LAM®, and ALLJOIST® products to comply with our specifications, to be free from defects in material and workmanship, and to meet or exceed our performance specifications for the normal and expected life of the structure when correctly stored, installed and used according to our Installation Guide.

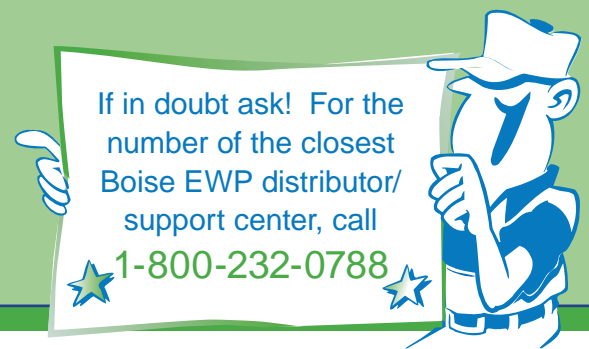

BCI, BC CALC, BC COLUMN, BC FRAMER, BC RIM BOARD, BOISE GLULAM, SIMPLE FRAMING SYSTEM, VERSA-LAM, VERSA-RIM, VERSA-STRAND, and VERSA-STUD are trademarks of Boise Cascade, L.L.C. or its affiliates.

The information in this document pertains to use in the UNITED STATES ONLY, Allowable Stress Design. Refer to the ALLJOIST Specifier Guide Canada for use in Canada, Limit States Design.

For information about Boise Engineered Wood Products, including sales terms and conditions, warranties and disclaimers, visit our website at www.BC.com/ewp

Your Dealer is:



Great products are only the beginning.™

If no dealer is listed, call 1-800-232-0788